

## Control knobs

### Aluminium

#### SPECIFICATION

Aluminium  
anodized, black

Indexing line  
white, engraved with laser precision

Stainless Steel-Grub screw DIN 916  
with internal hexagon and serrated point

#### INFORMATION

Control knobs GN 729 are usually selected for applications which require a limited movement within 180°.

With the aid of limiting pins which protrude into the circular groove the angle of rotation can be restricted. The bore  $d_4$  is for a spring plunger GN 614 (see page 847) to act as a simple detent. The indexing line is indelible and visible from two sides.

#### TECHNICAL INFORMATION

- ISO-Fundamental Tolerances (see page A21)

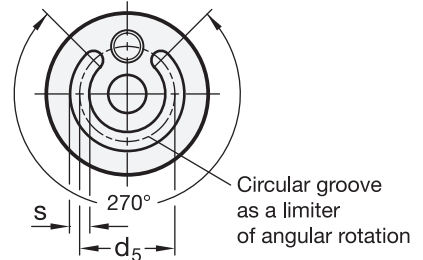
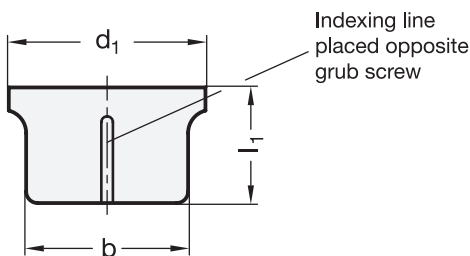
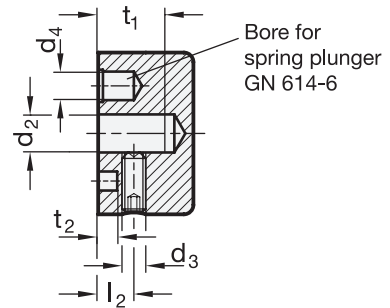
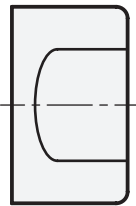
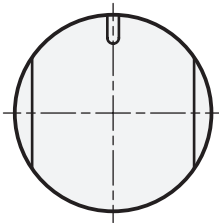

#### GN 729

Description	d1	d2 H8	b	d3	d4	d5	l1	l2	t1 min.	t2 +0.2	s +0.3/+0.1	
GN 729-34-B6	34	B 6	28	M 5	6	20	20	7.5	14	4	4	43
GN 729-34-B8	34	B 8	28	M 5	6	20	20	7.5	14	4	4	41
GN 729-42-B8	42	B 8	35	M 5	6	30	22	7.5	16	4	4	72
GN 729-42-B10	42	B 10	35	M 5	6	30	22	7.5	16	4	4	69